

PUNCH ASSEMBLY

MODEL: UP-20



PUNCH ASSEMBLY

UP-20 TECHNICAL SPECIFICATION

Solid Models & Videos Available Online

Our modular punch assemblies have a punch-and-die design to make custom shaped cut-outs. Our punch units use hardened steel tooling that is clean cutting and fast acting. The assembly can be mounted in any orientation, so you can add it to any converting, processing, or assembly line in any way you see fit! Just bolt it on!

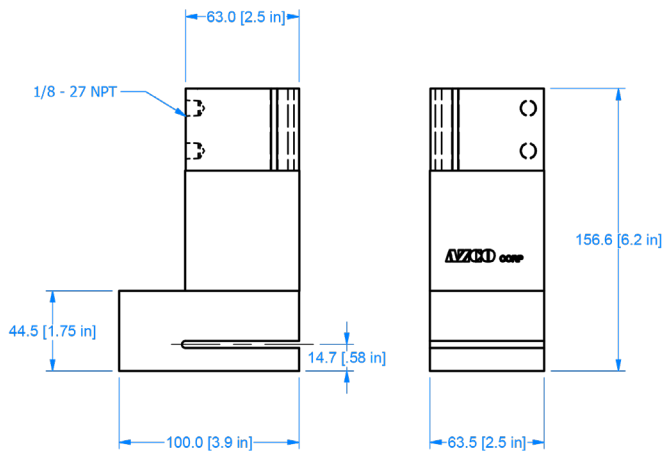

BENEFITS

- Clean cutting
- Fast acting
- Easily moved
- Mount in any orientation

MATERIALS

Film | Foam | Foil | Laminates | Medical Devices | Mesh | Metalized Film | Nonwovens | Paper | PTFE | Rubber | Shrink Tubing | Tape | Thin Gauge Metal

SPECIFICATIONS

- Modular design and construction
- Custom sizes and configurations
- Pneumatically operated punch
- Can be mounted in any orientation
- Hardened and precision ground matched punch and matrix
- Framework is supplied in clear anodized aluminum
- Punch and matrix will be a matched set
- Any design that fits within a 20mm [0.8"] diameter circle
- Centerline of punch is 38mm [1.5"] from edge of web and can be modified to meet your requirements
- NPT Fitting
- 90 psi (6 bar) compressed air

OPTIONS

- Custom shapes
- Extra depth throat
- Material guides
- Sensors
- Larger punches available



WARNING:

EQUIPMENT MUST BE GUARDED IN ACCORDANCE WITH ALL FEDERAL, STATE, AND LOCAL REQUIREMENTS.



CUSTOM FEEDING & CUTTING SOLUTIONS

26 Just Road, Fairfield, NJ 07004 | 973-439-1428 | azcocorp.com

